

# HAWSE PIPE, SQUARE

## 316 STAINLESS STEEL

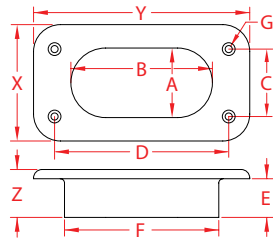

Import



Precision  
Cast

ITEM	A	B	C	D	E	F	G	FASTENER	X (height)	Y (length)	Z (width)	WT (lb)	PACKAGING TYPE	EACH (qty)	INNER (qty)	CARTON (qty)	UPC
S3806-0000	1.88"	3.92"	1.87"	4.85"	1.08"	4.25"	0.15"	#10	3.20"	6.00"	1.31"	1.29	POLYBAG	1	1	15	791506057956

**NOTE:**

**USE #10 FASTENERS.**

**ALL DIMENSIONS ARE NOMINAL (+/- 3%) AND ARE SUBJECT TO CHANGE WITHOUT NOTICE.**